

The LED Sector Range Light E8591 utilize high-efficient LED technology to provide narrow high intensity 3-colour sectored light beam guaranteeing the visibility range up to 10 nautical miles at night time. The lantern consists of a light unit and of marine grade aluminium case. The light unit consists of transparent polycarbonate front cover and of anodized base board which is used for dissipation of the heat.

On the site of installation the lantern will be fixed by a hot zinc coated base plate. The direction of the light beam around the horizontal axis is adjustable by rotation of the case with the light unit. Around vertical axis the direction of the light beam is adjustable by deflection of the light unit.

Features

- designed using Luxeon's revolutionary, energy efficient and ultra compact new STAR™ light source, combining the lifetime and reliability advantages of Light Emitting Diodes
- high intensity (up to 2000 cd) narrow 3-colour sectored light beam, adjustable around vertical and horizontal axes
- control of flashing using internal or external flasher of any available type
- it is possible to implement different flashing pattern for the light beams of different colours

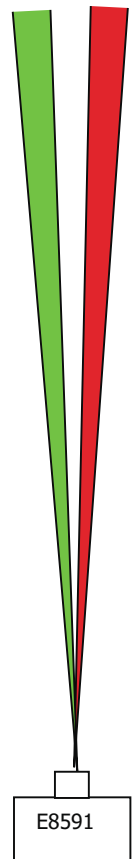

 **ekta** Cybernetica AS

Department of Navigation Systems EKTA

Call +372 639 7991

Fax +372 639 7992

E-mail: ekta@ekta.ee

Akadeemia tee 21, 12618 Tallinn, ESTONIA

Visit our website at www.ekta.ee

Technical specifications

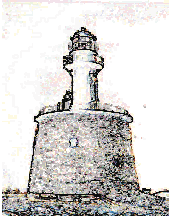

Parameter	Minimal	Typical	Maximal
Wavelength of red light	612 nm	625 nm	645 nm
Wavelength of green light	490 nm	505 nm	520 nm
Radiation temperature of white light	4500 K	5500 K	8000 K
Light intensity of all sectors	1800 cd	2000 cd	2900 cd
Width of the red sector*	1.5 deg		
Width of the green sector*	1.5 deg		
Width of the white sector*	1.9 deg		
Boundary resolution	2 angular minutes		
Vertical divergence	from +1.25 up to - 2.25 deg		
Control of flashing	by internal flasher or by external flasher of any type		
Voltage range	from 10 up to 30 V DC		
Power consumption in flash	14 W		
Ambient air temperature	from -30C upto +55C (IEC 60068-2-1 IEC 60068-2)		
Relative humidity	up to 98% at temperature +30C (IEC 60068-2-30)		
Operation in salt mist conditions	allowed (IEC 60068-2-52)		
Mechanical vibraton	10 – 500 Hz with acceleration up to 2.2 g (IEC 60945-8,7)		
Allowed wind speed	up to 140 km/h		
Ingress protection	IP 68 (IEC 60529)		
UV radiation tolerance	IEC 60060-2-5		

*) The width of a sector can be specified by the customer

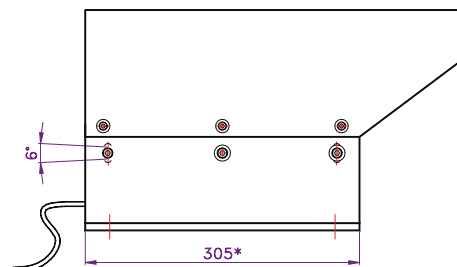
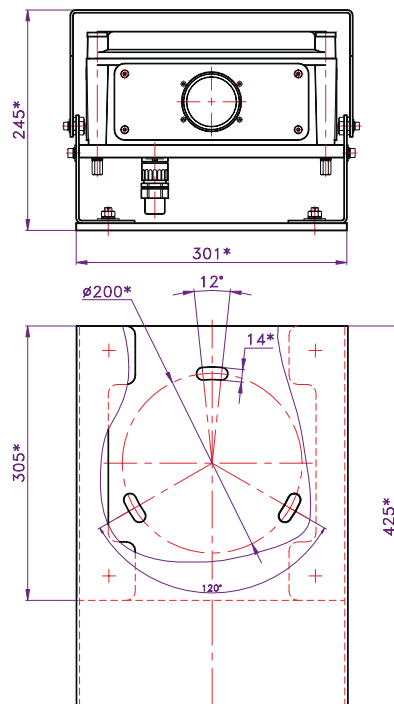

Layout and dimensions of the Sector Light E8591

